

# 2024 LSCLS/ASCLS-MS Joint Annual Meeting Preliminary Program At-A-Glance March 25-27, 2024



MGCCC Hospitality Resort Management Center (HRM)  
420 Debuys Road  
Biloxi, MS 39531

\*\*\*Note this is a Preliminary Program  
Please check back periodically for updates!

| Time              | Monday, March 25, 2024  |
|-------------------|---|
| 7:30am – 6:00pm   | Registration (South entrance HRM lobby)   |
| 7:30am – 8:00am   | MLS/MLT Student Bowl Organization Time (Judges, Moderators, Timekeepers to meet with coordinators)<br><b>MLS Command Center Classroom 209 - MLT Command Center - Board Room</b>   |
| 8:00am – 8:30am   | <b>MLS/MLT Student Bowl Reading of the Rules (Hall A)</b>   |
| 8:30am – 12:00pm  | MLS/MLT Student Bowl <b>Competition (MLS –211, 212,215,216,222 ) (MLT –Hall A)</b>  |
| 9:00am – 4:00pm   | <b>Career Fair – students come and go during student bowl competitions and explore potential employment opportunities – (1<sup>st</sup> floor Concourse HRM)</b><br>Career Fair vendor’s lunch hosted by Forrest Health Systems |
| 12:00pm – 12:45pm | <b>Box Lunches</b> for Student Bowl Participants, Instructors, Judges, and organizers   |
| 1:00pm – 3:30pm   | MLS/MLT Student Bowl <b>Competition continues</b>   |
| 3:30pm – 4:00pm   | <b>Break</b> for Student Bowl participants (Snacks provided)  |
| 4:00pm – 6:00pm   | MLS/MLT Student Bowl <b>Competition continues</b>   |
| 6:30pm – 9:00pm   | <b>Social Event</b> – Big Play Entertainment Center 1842 Beach Blvd. Biloxi, MS   |

| Time             | Tuesday, March 26, 2024  |
|------------------|--|
| 7:30am – 3:00pm  | Registration (South entrance HRM Lobby)  |
| 7:30am – 8:00am  | Continental Breakfast (City Line Café)   |
| 7:30am – 1:00pm  | Exhibitor and Vendor Setup (1 <sup>st</sup> and 2 <sup>nd</sup> floor Concourse HRM)   |
| 8:00am – 11:00am | MLS Student Bowl Finals (Hall B and Hall C)  |
| 8:30am – 9:30am  | <b>CE Session #1 (Hall A)</b>  |
|                  | <b>Student Engagement: The Good, The Bad, and The Ugly</b><br>Whitnee Brame, MS, MLS (ASCP) and Sonya Hidalgo, EdD, MLS (ASCP)<br>General Interest/Education - 1.0 CEU |

|                   |  |  |   |
|-------------------|--|--|---|
| 9:45am – 10:45am  | <b>CE Session #2 (Hall A)</b>  |  |   |
|                   | Artificial Intelligence in Education and at the Bench<br>Cindy Handley, PhD, MLS(ASCP) and Mary Warden, MS, MLS(ASCP) <sup>CM</sup><br>General Interest/Education and Management - 1.0 CEU |  |   |
| 11:15am – 12:30pm | <b>Student Forum – Elections and Boxed lunch provided for students</b>   |  |   |
|                   | LSCLS - Louisiana Student Forum<br>Room - Classroom 212  | ASCLS-MS - Mississippi Student Forum<br>Room - Hall A  |   |
| 11:15am – 12:30pm | <b>State Society Business Meetings – Boxed Lunches provided</b>  |  |   |
|                   | LSCLS - Louisiana State Business Mtg<br>Room - Classroom 222   | ASCLS-MS - Mississippi State Business Mtg<br>Room - Classroom 211  |   |
| 12:45am – 1:45pm  | <b>Opening Keynote Address - CE Session #3 iMPAC building (see map #37)</b>  |  |   |
|                   | <b>Arthropods in Clinical Medicine</b><br>Jerome Goddard, PhD<br>Microbiology - 1.0 CEU  |  |   |
| 1:00pm – 4:30pm   | Private Vendor Fair – <b>Invitation ONLY</b>   |  |   |
| 2:00pm – 3:00pm   | <b>Session #4</b>  | <b>Session #5</b>  | <b>Session #6</b>   |
|                   | Room: Hall C   | Room: Hall B   | Room: Hall A  |
|                   | <b>Skills Needed to be a Successful Lab Traveler</b><br>Norma Bivona, MLS(ASCP) <sup>CM</sup><br>General Interest - 1.0 CEU  | <b>CSF Assays for Alzheimer’s Disease: Supporting the Path to an Earlier Diagnosis</b><br>Eric Dyne, PhD<br>Clinical Chemistry - 1.0 CEU | <b>DCLS, What Does It Actually Mean?</b><br>Elizabeth M. Stepp, MLS(ASCP) <sup>CM</sup><br>General Interest - 1.0 CEU |
| 3:00pm – 3:30pm   | <b>Break</b>   |  |   |
| 3:30pm – 4:30pm   | <b>Session #7</b>  | <b>Session #8</b>  | <b>Session #9</b>   |
|                   | Room: Hall A   | Room: Hall B   | Room: Hall C  |
|                   | <b>Laboratory Management for Different Associate Styles</b><br>Lacey A. Campbell, MHS,<br>MLS(ASCP) <sup>CM</sup><br>General Int/Mgmt 1.0 CEU  | <b>Detecting Mild Traumatic Brain Injury</b><br>Karrie Hovis, MHS, MLS(ASCP) <sup>CM</sup><br>Clinical Chemistry 1.0 CEU                 | <b>Microbiology Student Review</b><br>Janet E. Cooper, MSNS,<br>BSMT(ASCP)H<br>Microbiology 1.0 CEU                   |
| 4:45pm – 7:00pm   | <b>Exhibits – Vendor Appreciation and Reception – all welcome with paid registration</b><br><b>Silent Auction Items Displayed for Bidding (Hall C)</b>                                     |  |   |

|                  |   |
|------------------|---|
| <b>Time</b>      | <b>Wednesday, March 27, 2024</b>  |
| 7:00am – 12:00pm | Registration  |
| 7:00am – 8:00am  | Continental Breakfast (City Line Café)  |
| 7:15am – 8:15am  | <b>CE Session #10 Classroom 222</b>   |
|                  | <b>To Infinity and Beyond: When It's More Than Just a Job</b><br>Elizabeth M. Stepp, MLS (ASCP) <sup>CM</sup><br>General Interest - 1.0 CEU   |
| 8:00am – 12:00pm |  <b>Vendor Fair Open (1<sup>st</sup> and 2<sup>nd</sup> floor Concourse HRM)</b>  |

|   |   |  |  |
|---|---|--|--|
| 8:30am – 9:30pm   | <b>CE Session #11 Classroom 222</b>   |  |  |
|   | <b>Natriuretic Peptides: Scientific Evidence Supporting Analytical and Clinical Application</b><br>Eric Dyne, PhD<br>Clinical Chemistry - 1.0 CEU |  |  |
| 9:40am – 10:40am  | <b>CE Session #12</b>   | <b>CE Session #13</b>  | <b>CE Session #14</b>  |
|   | Room: Classroom 211   | Room: Classroom 212  | Room: Hall C   |
|   | <b>Understanding RHCE Variants and their Impact on Patient Management</b><br>Katrina Billingsley, MSTM, MLS(ASCP)SBB<br>Immunohematology 1.0 CEU  | <b>Deficiencies and What To Do</b><br>Carolyn Preston, MLS(ASCP) <sup>CM</sup><br>Gen Interest/ Mgmt 1.0 CEU | <b>Immunohematology Student Review</b><br>Katie Patrick, MS, MLS(ASCP) <sup>CM</sup><br>Immunohematology 1.0 CEU   |
| 10:50am – 11:50am   | <b>CE Session #15</b>   | <b>CE Session #16</b>  | <b>CE Session #17</b>  |
|   | Room: Classroom 211   | Room: Classroom 212  | Room: Hall C   |
|   | <b>The Mindful MLS</b><br>Kerry M. Touns, MS, MLS (ASCP)<br>General Interest 1.0 CEU  | <b>Uh Oh, I Have an Interview...Now What?</b><br>Frank Duke, BSN, RN, CCEMT-P<br>General Interest 1.0 CEU    | <b>Hematology/Coagulation Student Review</b><br>Jana Bagwell, PhD, MLS(ASCP) <sup>CM</sup> MB and Shamonica King, PhD, MA, MLS(ASCP) <sup>CM</sup><br>Hematology 1.0 CEU |
| 12:00pm – 2:00pm  | <b>Awards Luncheon / Silent Auction Announced (provided with registration) (Halls A-C)</b>  |  |  |
| 2:15pm – 3:15pm   | <b>CE Session #18</b>   | <b>CE Session #19</b>  | <b>CE Session #20</b>  |
|   | Room: Classroom 211   | Room: 212  | Room: Halls A-C  |
|   | <b>Bacteriology - It's Role in Public Health</b><br>Becky Hardgrove, MS<br>Microbiology 1.0 CEU   | <b>Retirement! Life after the Lab</b><br>Evelyn Weaver, MS, MLS, ASCP<br>General Interest 1.0 CEU            | <b>Clinical Chemistry Student Review</b><br>Lacey A. Campbell, MHS, MLS(ASCP) <sup>CM</sup><br>Clinical Chemistry 1.0 CEU  |
| 3:25pm – 4:25pm   | <b>CE Session #21</b>   |  | <b>CE Session #22</b>  |
|   | Room: Classroom 211   |  | Room: 212  |
|   | <b>Histology</b><br>Holly Johnson MLT (ASCP)<br>General Interest 1.0 CEU  |  | <b>Hematology SuperTech: Perfecting Your Smear Analysis</b><br>Shamonica King, PhD, MA, MLS(ASCP) <sup>CM</sup><br>General Interest 1.0 CEU                              |
| <b>Closing Keynote Address - CE Session #23 (Halls A-C)</b>   |   |  |  |
| 4:30pm – 5:30pm   | <b>"Oh, Crap!" Moments in Blood Banking</b><br>James Gardner, MLS(ASCP)SBB<br>Immunohematology 1.0 CEU  |  |  |
| 5:30 pm   | <b>Meeting Adjourned</b>  |  |  |
| <p>The sessions associated with this educational program have been approved by the ASCLS P.A.C.E.® program. P.A.C.E.® is accepted by the ASCP Board of Certification (BOC), and all states, including California and Florida, as an approved provider of continuing education for recertification and licensure. ASCLS members may use CE Organizer to build CEU certificates and have them automatically downloaded to the ASCP Board of Certification. Visit: <a href="http://www.ascls.org/education-meetings/ce-organizer">http://www.ascls.org/education-meetings/ce-organizer</a></p> |   |  |  |

MGCCC Hospitality Resort Management Center  
420 Debuys Rd, Biloxi, MS 39531

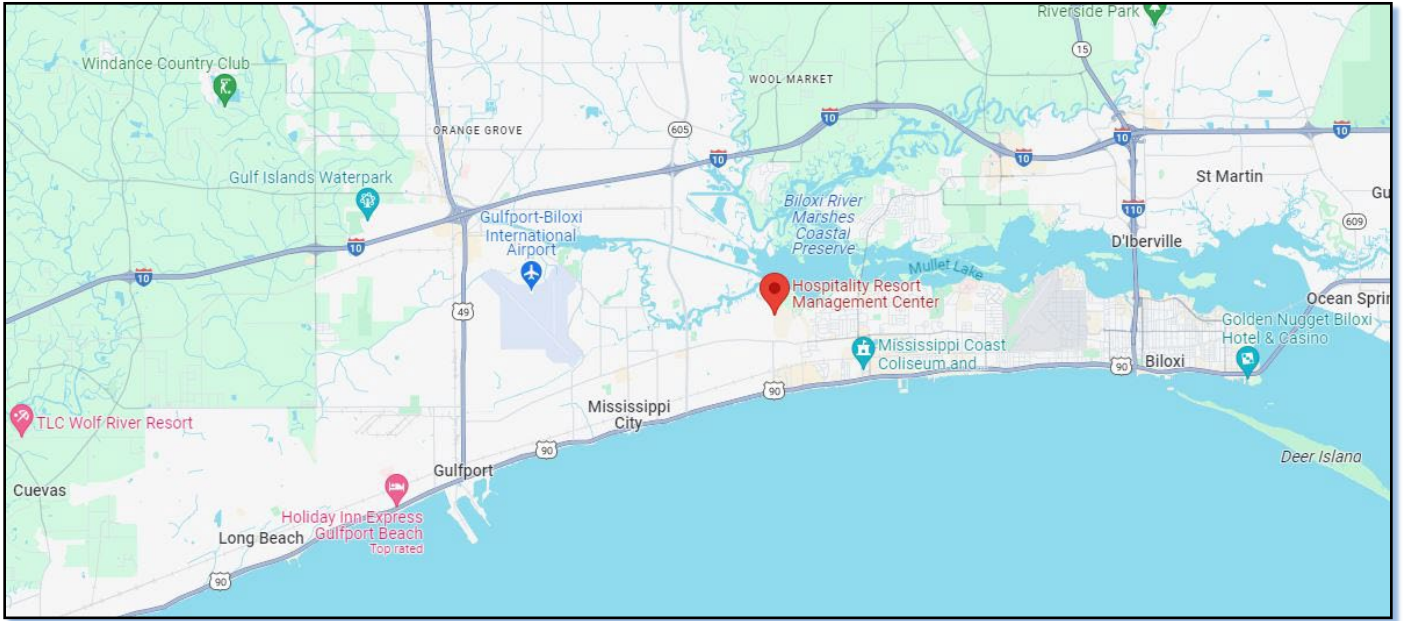

### MGCCC Harrison County Campus Map

- #36 - Hospitality & Resort Management Building
- #37 - Immersive Performing Arts Center (iMPAC) Building

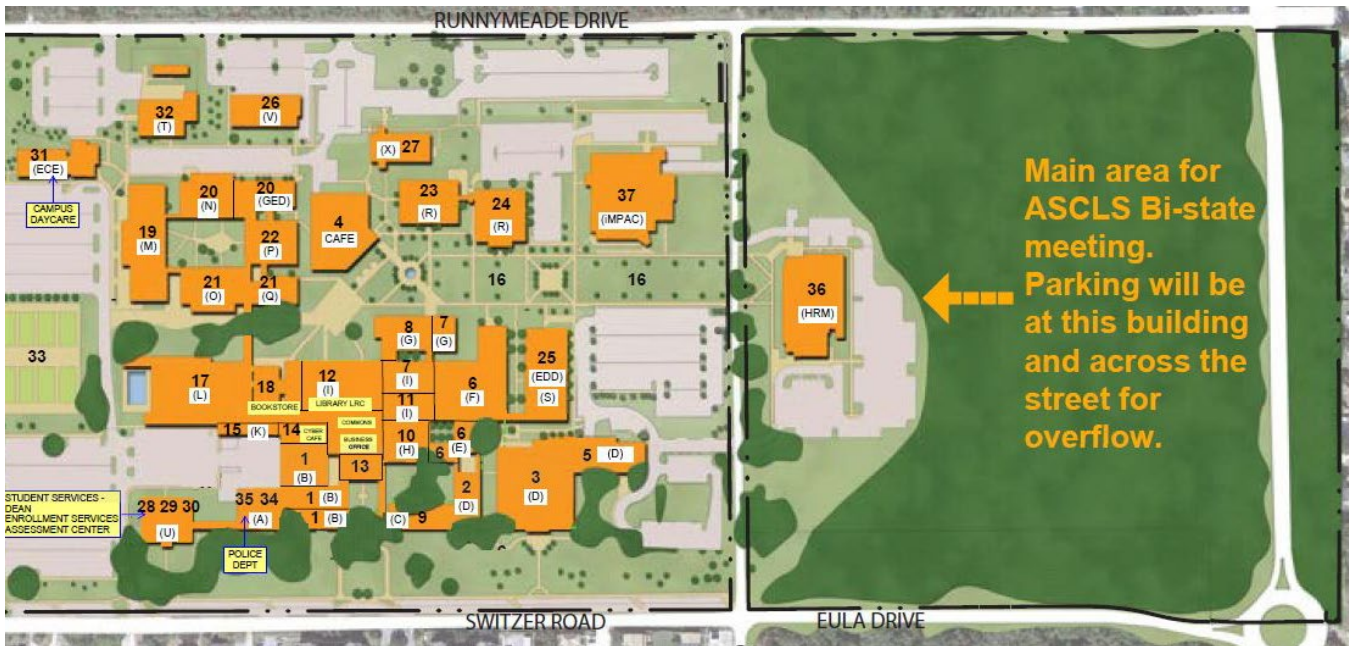



## First Floor HRM

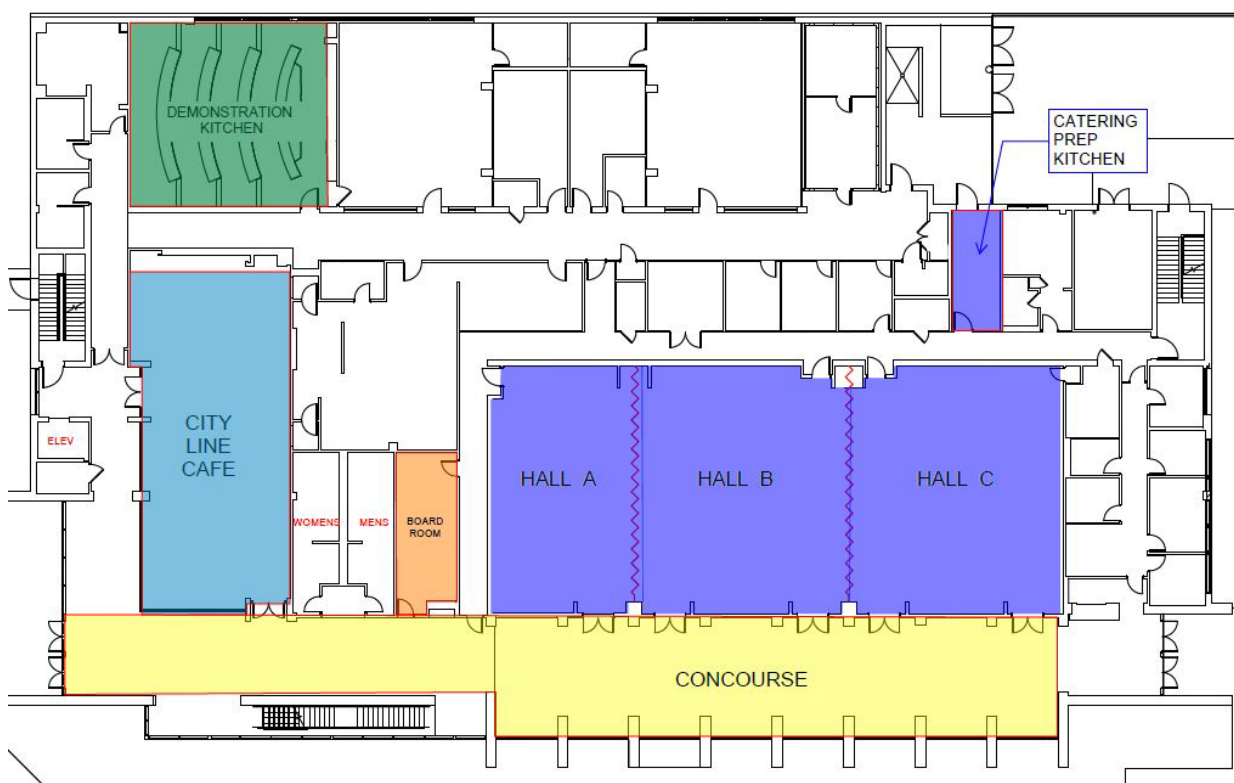

## Upstairs HRM

